

## Rugged, High Capacity Dry Pump!

- Pumping speed: 400, 650, 800 m<sup>3</sup>/h
- Ultimate pressure: 5 Pa
- Corrosion-resistant materials can be selected according to the process
- Internal cleaning function using solvent (optional)
- Cooling water

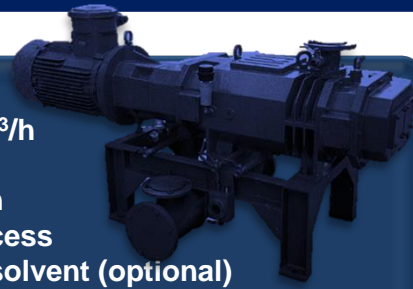

## Specifications

Model		SCO400(-C)	SCO650(-C)	SCO800(-C)
Performance	Ultimate pressure (Pa)	5.0		
	Maximum pumping speed (m <sup>3</sup> /h)	400	650	800
Motor	Power supply	三相 380V 50Hz		
	Power consumption (kW)	11	18.5	18.5
	Remark	Ordinary motor IP55※Various voltages and explosion-proof motors are also available (manufactured to order)		
Dimensions	Width (mm)	920	1060	1060
	Length (mm)	1335	1600	1750
	Height (mm)	870	980	980
	Weight (kg)	570	840	1220
	Inlet port	ISO65	ISO100	ISO150
	Outlet port	ISO65	ISO80	ISO100
Lubrication	Oil capacity (L)	1.2	1.8	1.8
	Oil	OKO100		
Cooling	Cooling water flow rate (L/min)	15	18	20
	Cooling water port	G1/2	G1/2	G1/2

## Pumping rate Curve

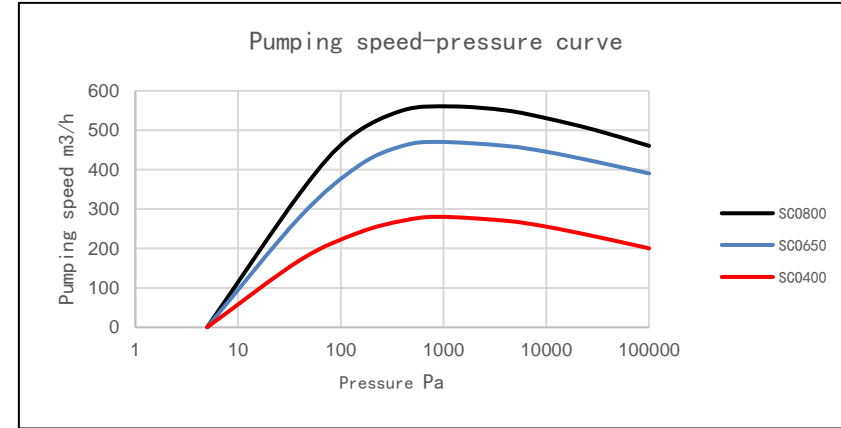

## Dimensions (mm)

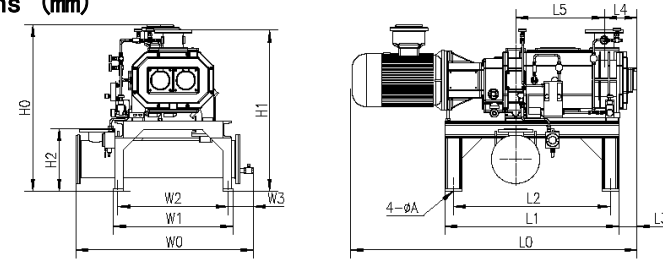

Type	W0	W1	W2	W3	H0	H1	H2
SCO400	920	570	520	155	870	790	280
SCO650	1060	700	650	155	980	945	367
SCO800	1060	700	650	155	980	945	367
Type	L0	L1	L2	L3	L4	L5	φA
SCO400	1335	910	810	105	160	460	20
SCO650	1600	1020	920	105	190	520	20
SCO800	1750	1095	995	105	190	605	20